

- Foul Notes:
1. Read this drawing in conjunction with all other relevant Engineers and Architects drawings.
 2. Do not scale this drawing, use only written dimensions.
 3. Do not set out from this drawing unless specifically confirmed by the Engineers beforehand.
 4. All levels shown are to Malin Head datum (mOD).
 5. The contractor is to check all service connections before commencing any site development works.
 6. The Engineer is to be informed of discrepancies that may arise before the contractor commences any site development works, if in doubt - ask!
 7. Manhole details and materials specification to comply Irish Water Wastewater Infrastructure Standard Details document and Code of Practice.
 8. Foul gravity sewers to be concrete in accordance with IW CoP section 3.13.
 9. Refer also to the Manhole details drawing provided for further information.
 10. Where cover to pipes is less than 1.2m in roads, 1.0m in public areas and 0.9m in grassed/landscaped areas, surround the pipe 150mm of concrete.
- THIS PLANNING DRAWING IS FOR APPROVAL BY IRISH WATER CDS SECTION

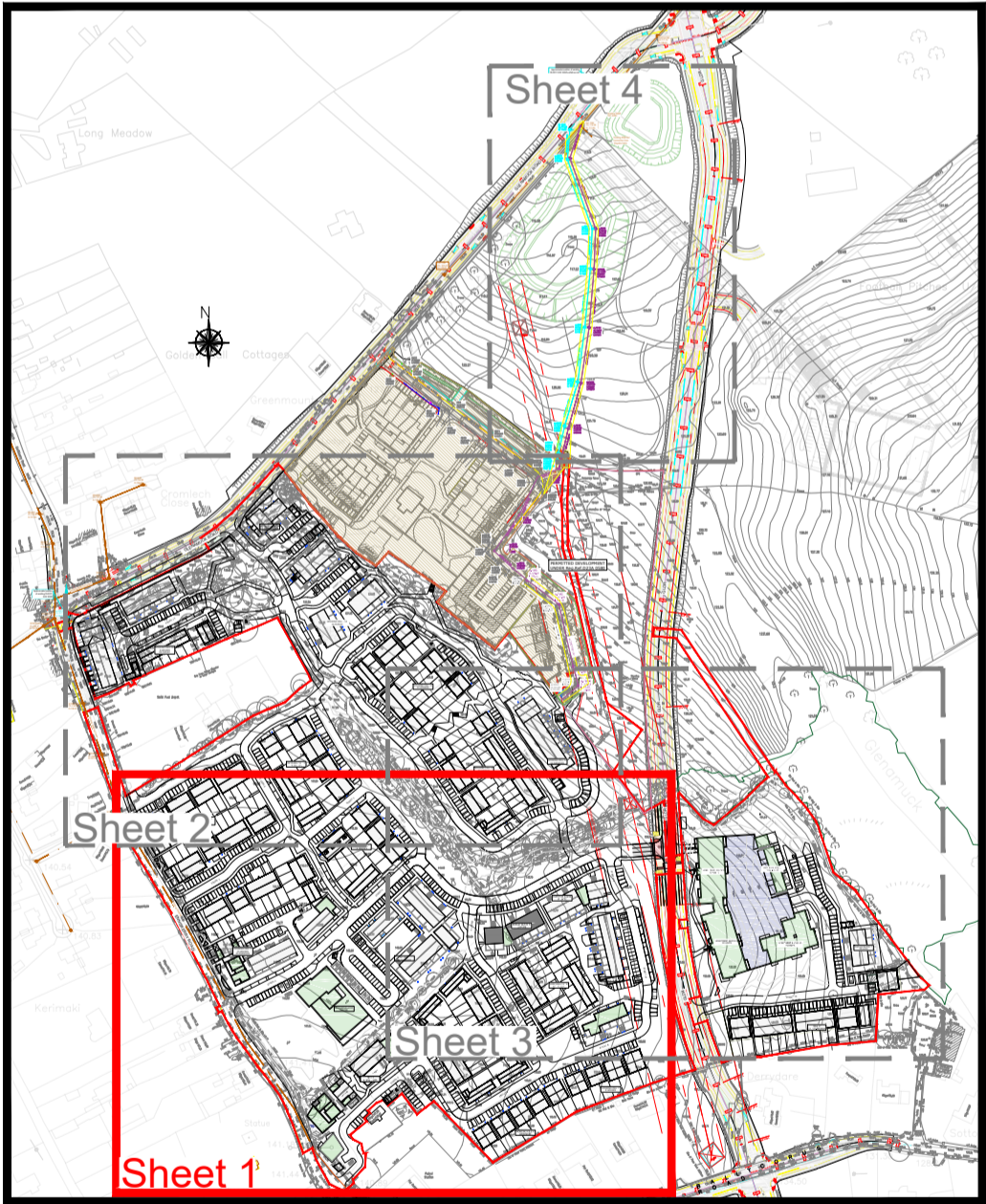

Key Plan
A1 Scale 1:5000

Foul Drainage Legend

Proposed Foul Sewer/Manhole	Proposed connection and inspection chamber
Proposed cover level/Invert level	S/W Manhole, Invert Level, Diameter & Gradient

REV	DATE	DESCRIPTION
ROGER MULLARKEY & ASSOCIATES Consulting Structural and Civil Engineers Duncreevan, Kilcock, Co.Kildare Tel: +353 1 610 3755 Mob: +353 87 232 4917 E-mail: info@rmullarkey.ie www.rmullarkey.ie		
Project KILTERNAN VILLAGE LRD		
Drawing Title FOUL DRAINAGE LAYOUT- Sheet 1		Architect MCORM Architects
Date Oct'23	Drawn By RM	Scales 1:500 @A1
Dwg.No. 2104C/307	Stage LRD STAGE 3	Rev